

Ampatex® Solero (plus)

Formwork membrane, weather-resistant vapour check and airtight layer



- 3-ply. Two polypropylene fleeces on either side of the functional membrane
- Ampatex® Solero plus also available with integrated tapes on both sides
- Weather resistant
- Robust and flexible, even at low temperatures
- Does not stretch or shrink

Technical details		Value	Standard
Product description		Type A	EN 13984:2013
Mass per unit area		145 g/m ²	EN 1849-2
s _p value		5m	EN 1931
Straightness		< 75 mm / 10 m	EN 1848-2
Fire performance		E	EN 13 501-1
Waterproofing (at 2 kPa)		passed	EN 1928, procedure A
Tear resistance	longitudinal	240 N/5 cm	EN 12 311-2/
	transverse	180 N/5 cm	EN 13 859-1
Tear elongation	longitudinal	40 %	EN 12 311-2/
	transverse	40 %	EN 13 859-1
Resistance to further tearing (nail shaft)	longitudinal	110 N	EN 12 310-1/
	transverse	120 N	EN 13 859-1
Water vapour resistance after ageing		passed	EN 1296, 70°C EN 1931
Airtightness		airtight	
Hazardous substances		none	
Visible defects		none	EN 1850-2
Minimum roof slope		10°	
Width of overlap		10 cm	

10
 Jahre Garantie
 Ans Garantie
 Anni Garanzia
 Years Warranty

Security is part of the system at Ampack. We not only cover the cost of the materials, but also the installation and removal costs.

CE
 EN 13984

ISO 9001
 Swiss Research

Areas of application: for internal and external pitched roofs, polished and unpolished timber frameworks, outside under the insulation.

Forms of delivery

Article number	Description	Roll dimensions	Content of pallets
7640115535009	Ampatex® Solero	1,5 m × 50 m = 75 m ²	24 rolls = 1'800 m ²
7640115535214	Ampatex® Solero plus with integrated tapes on both sides	1,5 m × 50 m = 75 m ²	24 rolls = 1'800 m ²
7640115535627	Ampatex® Solero	3 m × 50 m = 150 m ²	24 rolls = 3'600 m ²

Warm roof, over-rafter insulation system

DA 001

11	Roof membrane Ampatop® Protecta
13	Formwork membrane Ampatex® Solero
29	Adhesive tape Ampacoll® XT , 60 mm
47	Nail sealing tape Ampacoll® ND.Band

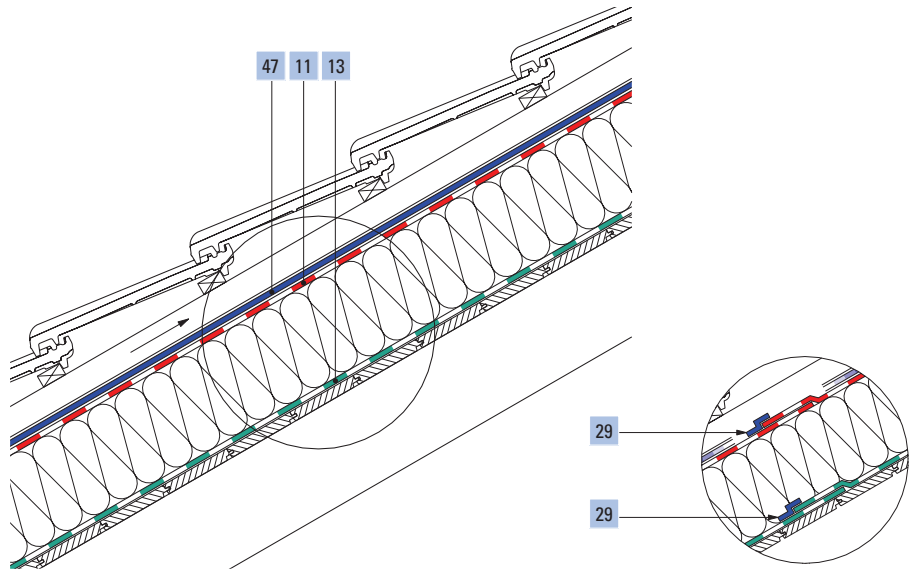

Ampacoll® XT
For overlaps



Ampacoll® Superfix
For edge joints



Ampacoll® BK 535
For penetrations



Processing tips

Ampatex Solero® is a weather-resistant vapour check and an airtight layer in one. All seams, gaps, overlaps, joints and penetrations must be constructed to be airtight. Any damage to the area must be sealed.

Ampatex Solero® is mostly used on the warm side of the heat insulation layer. The membrane is laid parallel to the eaves on the existing flat

substructure and the overlaps (10 cm) are nailed and covered. Overlaps are glued with **Ampacoll® XT**. Edging on chimneys, skylights, enclosure walls, etc., must be bonded with **Ampacoll® BK 530**, 20 mm, at least 15 cm high.

Penetrations such as outlet vents, chimneys, etc., must be sealed with **Ampacoll® BK 535**, 50 or 80 mm, butyl rubber tape to make them airtight and

rainproof. Porous, dusty or rough surfaces should be pretreated with **Ampacoll® Primax** or **Airmax**.



Note the application guidelines and other system products in our adhesive matrix



For more detailed information and documents see www.ampack.biz

Sales through dealers

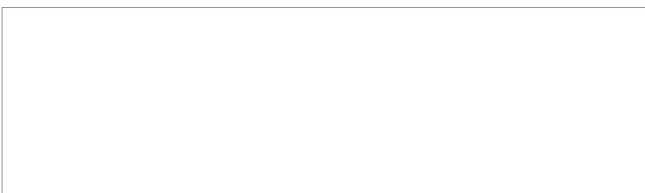

This data may become invalid as a result of new information or development. Current information can be found at www.ampack.biz © Ampack AG

Ampack AG

Seeblichstrasse 50
9401 Rorschach
Tel. +41 (0)71 858 38 00
Fax +41 (0)71 858 38 37
ampack@ampack.ch
www.ampack.biz

