

Ampatex® Variano 3

Moisture-variable vapour check and airtight layer



NEW: most reliable moisture-variable vapour check



- > Moisture-variable vapour check of the 3rd generation: maximum expansion and thus maximum reliability in moisture-critical constructions
- > Excellent adhesive properties
- > Ideal for exhaust insulation highly resistant to tears by nails
- > Hydrosafe effect and ridge protection when used on bare brickwork or concrete in winter

Technical details		Value	Standard
s _D value		0.80m-60m	EN 1931
Weight		90g/m ²	EN 1849-2
Tear-proof qualities	lengthwise	180N/5 cm	EN 12311-2/A
	cross	125N/5 cm	
Elongation at break	lengthwise	≥68%	EN 12311-2/A
	cross	≥79%	
Resistance to further tearing (nail shank)	lengthwise	125 N	EN 12310-1
	cross	110 N	
Fire behaviour		E	EN 13501-1
Watertight at 2 kPa		standard met	EN 1928
Width of overlap		10cm	
Straightness		< 75 mm/10m	EN 1848-2
Temperature resistance		-40 bis +80°C	
Remains durable after artificial ageing		standard met	EN 1296
Shear resistance of joint seams		130 N	EN 12317-2

10 Jahre Garantie
Ans Garantie
Anni Garanzia
Years Warranty

CE
13984

ISO 9001
Swiss Research

Area of application: Perfectly suited for flat roofs in timber construction; also for renovating pitched roofs with a dense outer skin. The tape offers special protection when used on bare brickwork in winter.

Delivery forms			
Item no.	Identification	Roll dimensions	Pallet contents
7640115536815	Ampatex® Variano 3	1,5m × 50m = 75 m ²	40 rolls = 3,000 m ²
7640115536983	Ampatex® Variano 3	3,0m × 50m = 150 m ²	40 rolls = 6,000 m ²

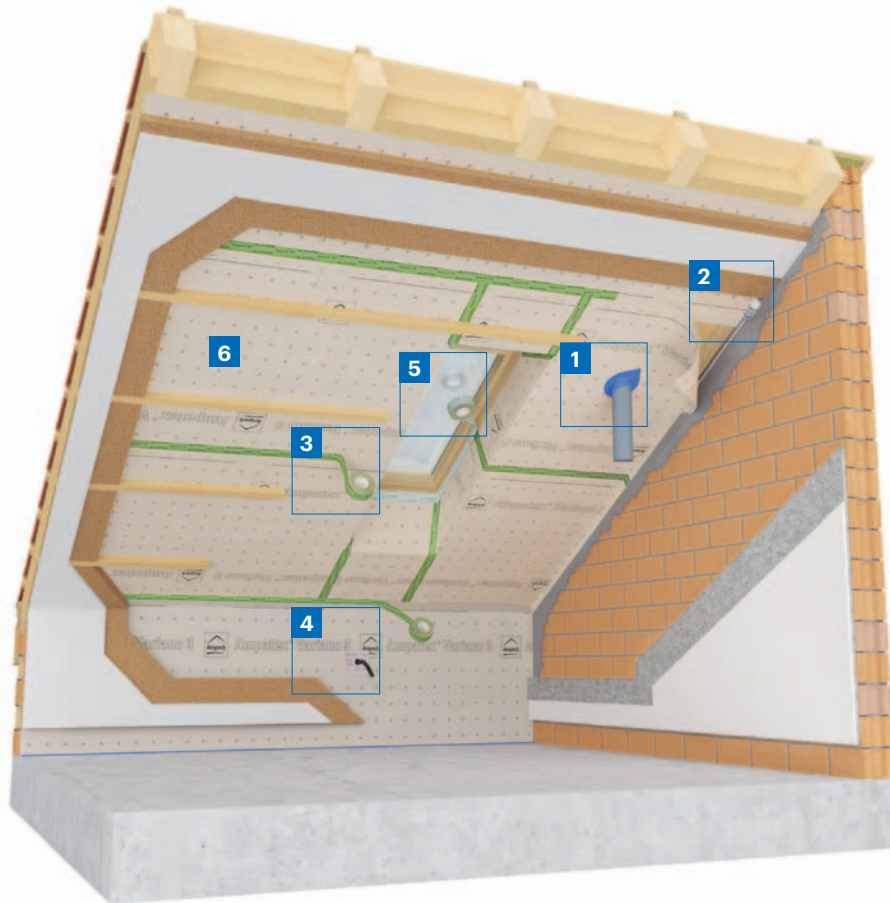

- 6 Ampatex® Variano 3**
Moisture-variable vapour check and airtight layer



Application tips

Ampatex® Variano 3 is applied as an airtight layer and moisture-variable vapour check for dry interior finishing and positioned on the warm side of the thermal insulation where it is stapled to the construction. Take care when positioning it that the membranes overlap by 10 cm and that the joints are tightly sealed with the enclosed system adhesive strip **Ampacoll® INT**.

Edge connections must be sealed with **Ampacoll® BK 530** or **Ampacoll® RA**. Porous or dusty surfaces must be pretreated with **Ampacoll® Primax**. Penetrations such as ventilation and electric pipes must be permanently sealed with **Ampacoll® BK 535** or **Ampacoll® Elektro u. Install** sleeves.



Please observe the recommendations for use and further system products in our adhesives matrix



Further information and detailed documentation at www.ampack.biz

Sales via specialist dealers

Ampack Switzerland: 071 858 38 00
Ampack Austria: 05523 53433
Ampack Germany: 07621 1610264
Ampack France: 04 50 83 70 54
Ampack Italy: 0471 053 475

www.ampack.biz



The following information may have been superseded by new findings or developments. Current Information can be found at www.ampack.biz. © Ampack AG, Rorschach, 06/2018

4126EU/EXX.YYHW(VS)0618